

Detail "X"
Cake outlet /
(Sortie boues deshydratées)
Sc.: 1:20

Theoretical loads distributed among the 4 legs
(C-Press in operation) /
Charges théoriques sur les 4 pieds
(C-Press en fonctionnement)

Leg	Load
P1	30960 N
P2	30960 N
P3	17120 N
P4	17120 N

Theoretical loads distributed among the 4 legs
(Reaction tank in operation) /
Charges théoriques sur les 4 pieds
(Floculateur en fonctionnement)

Leg	Load
P5	4200 N
P6	4200 N
P7	4200 N
P8	4200 N

Detail "Y"
Sc.: 1:10

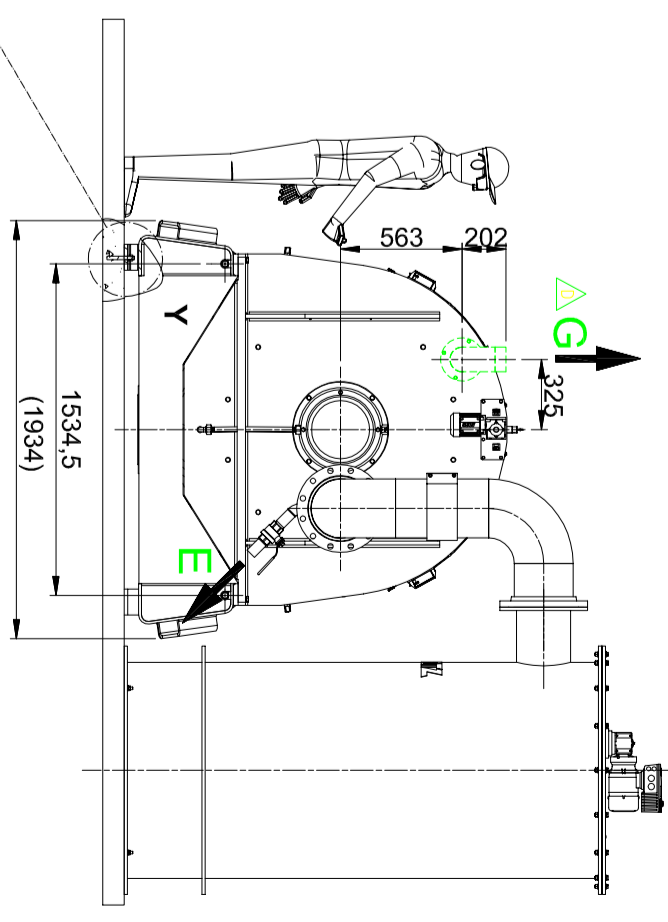

View "W"
Sc.: 1:35

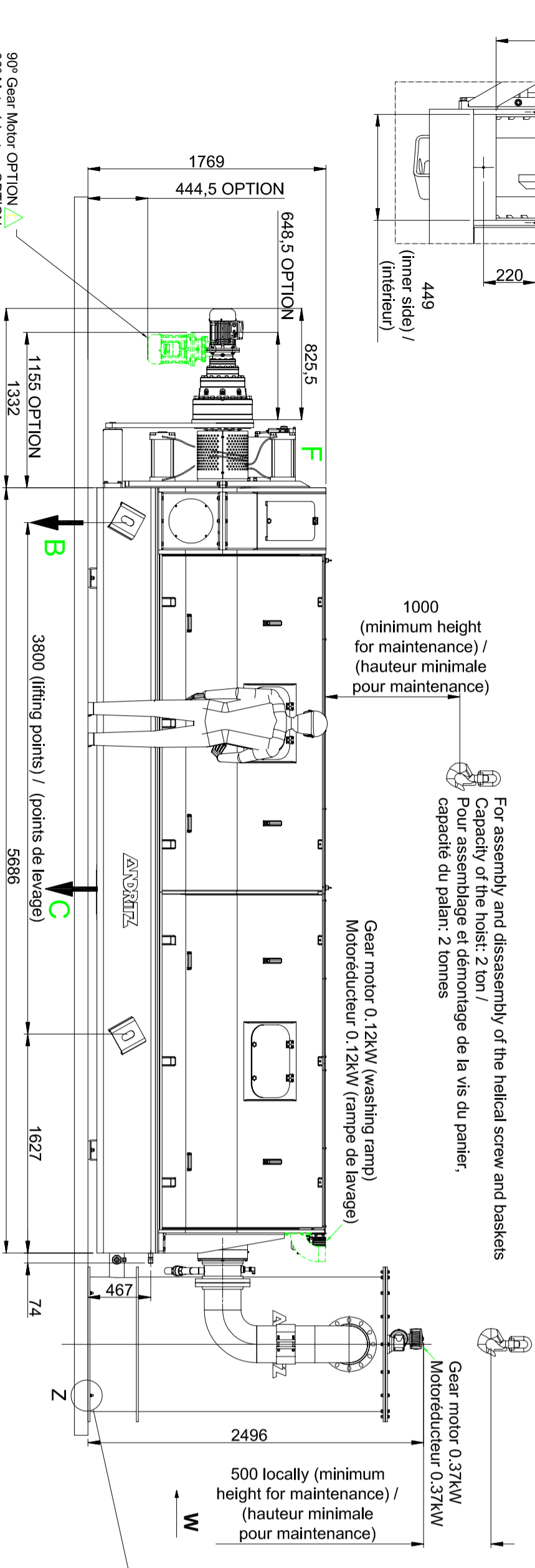

Detail "Z"
Sc.: 1:10

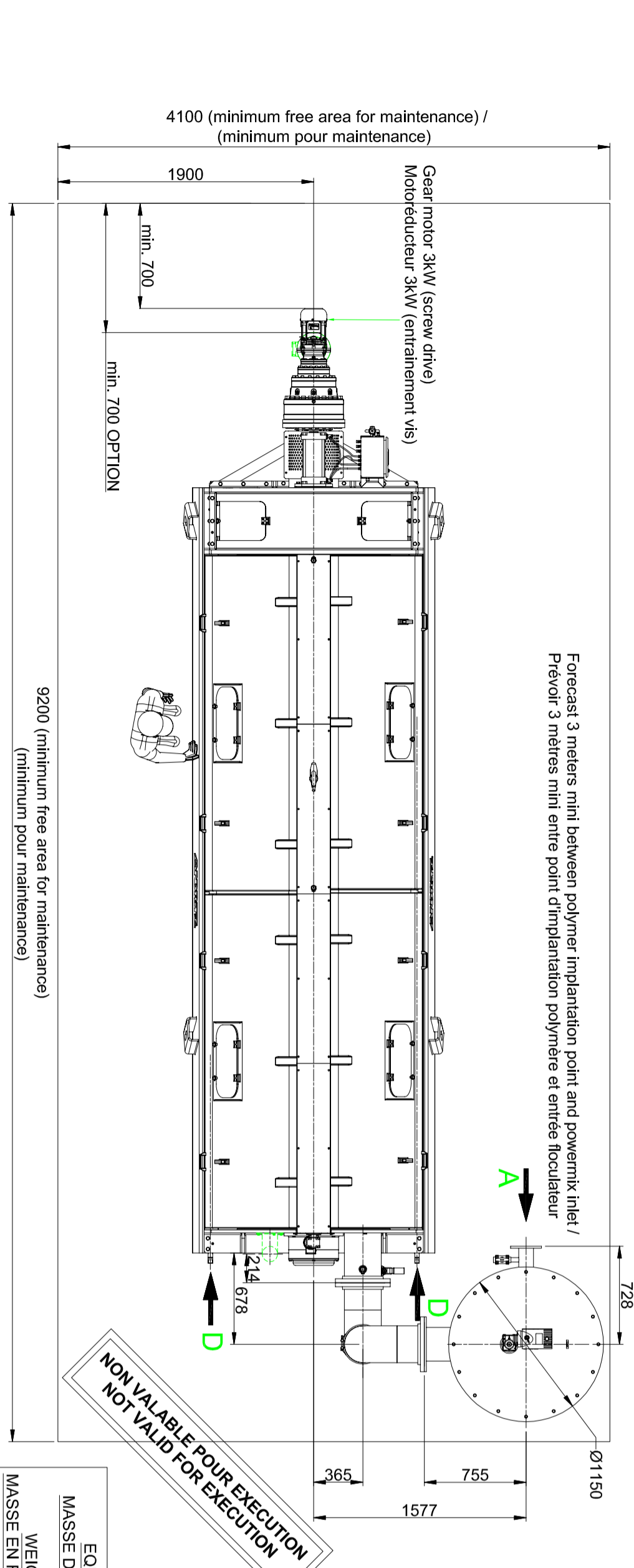
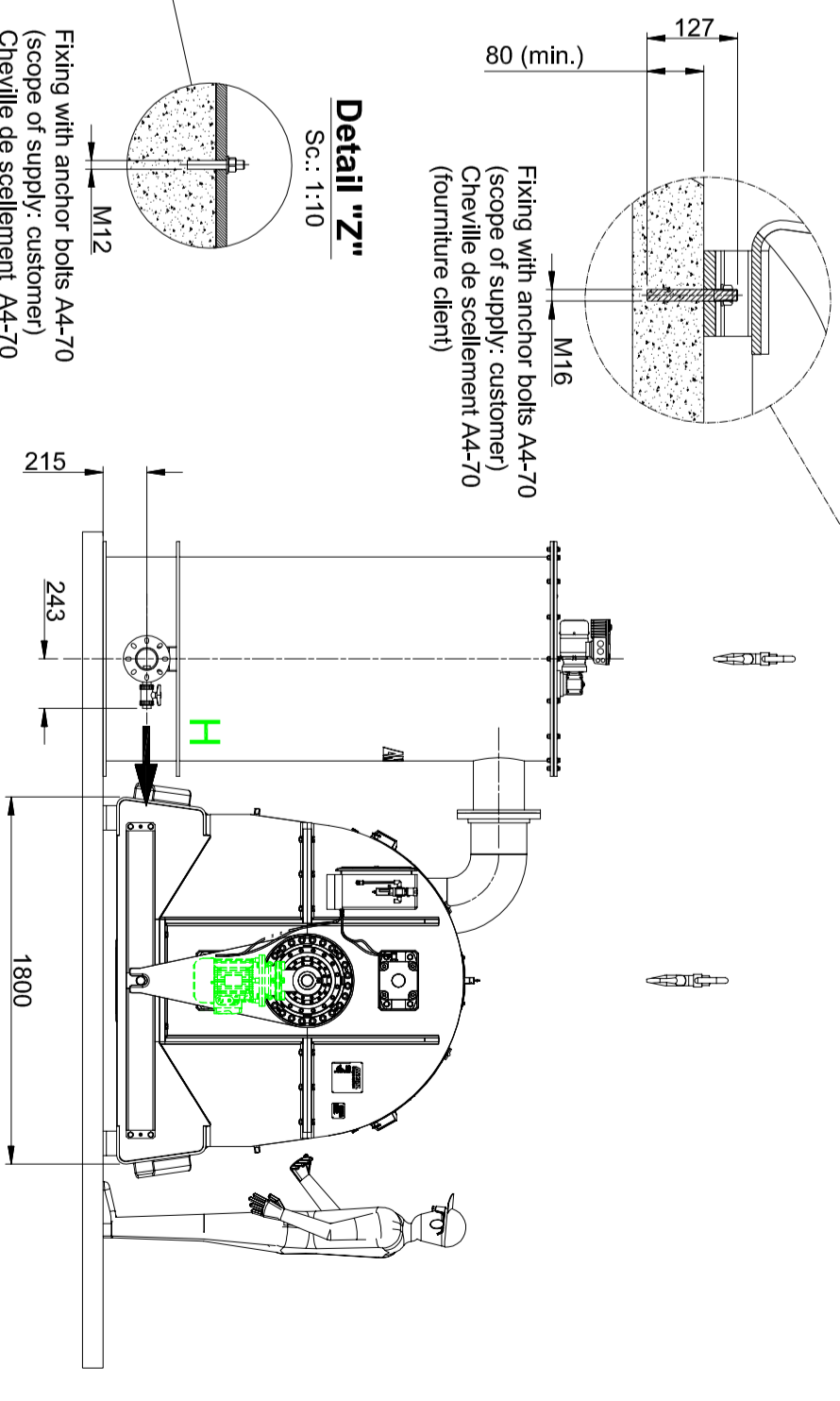

Forecast 3 meters mini between polymer implantation point and powermix inlet /
Prévoir 3 mètres mini entre point d'implantation polymère et entrée floculateur

EQUIPMENT WEIGHT /
MASSE DE L'EQUIPEMENT: 7750kg
WEIGHT IN OPERATION /
MASSE EN FONCTIONNEMENT: 11800kg

**NON VALABLE POUR EXECUTION
NOT VALID FOR EXECUTION**

Item / Repère	Description	Size / Taille	Detail
A	Sludge inlet / Entrée boue	DN 100 DIN EN 1092-1 PN10 OR 4" ANSI B16.5 - 150 Lbs	Flange / Bride
B	Cake outlet / Sortie sédiment	1233 x 449 (8 M10)	Rectangular hole / trou rectangulaire
C	Filtrate outlet / Sortie filtrat	DN 250 DIN EN 1092-1 PN10 OR 10" ANSI B16.5 - 150 Lbs (option)	Flange / Bride
D	Wash water inlet / Entrée eau lavage	2 x 1" BSP male	Threaded / Fileté
E	Sample taking point (feed) / Prise échantillon	Ø48.3	Pipe / Tube
F	Pneumatic panel / Boîtier pneumatique	300 x 200 x 155 - OD 8mm	Pipe / Tube
G	Deaeration (option) / Désodorisation (option)	Ø114.3	Pipe / Tube
H	Drain / Vidange floculateur	DN25	Valve female / Vanne femelle

Product Code	Product Code
702517416	702517416

SCREW PRESS
10050 + POWERMIX 1070L

SCREW PRESS
10050 + FLOCCULATEUR 1070L

Drawing No	Rev
702517416	D

Size	Sheet/Sheets	Scale
A2	1 / 1	-

ANDRITZ